



- An immaculate and extended semi-detached property enjoying a secluded location
- Lounge with double doors opening into the dining room with feature log burner
- Attractive fitted kitchen, separate utility room and ground floor w.c.
- Ground floor extension providing second lounge, fourth bedroom and or study
- Three bedrooms all with fitted wardrobes and family bathroom with shower over bath
- Three car private drive, large adjoining garage and extremely private rear garden with timber studio



An immaculately presented and extended semi-detached house, located in a quiet and secluded position. The entrance hallway and landing boasts feature panelling to walls. The lounge positioned to the front of the property has double doors opening into the dining room which boasts a log burner and patio doors opening onto the rear garden. Attractive fitted kitchen with window overlooking garden, connecting to a separate utility room and handy ground floor w.c. From the utility a lobby area provides direct access to the garage and a door into a second lounge and fourth bedroom or study with a door onto garden. On the first floor are three good sized bedrooms all with fitted wardrobes and a family bathroom with shower over bath. Gas central heating and double glazing. Externally the property is approached via private drive, which provides comfortable parking for three vehicles side by side, on from this is a sheltered area perfect for storing logs and protecting the front door from the weather. The adjoining garage is large, has power and lighting and a pitched roof with two Velux windows (this area could be further accommodation is required). The rear garden is extremely private has a decked patio, artificial lawn and mature planting. Timber garden studio with power and lighting.

**Tenure:** Freehold

**Council Tax Band:** C



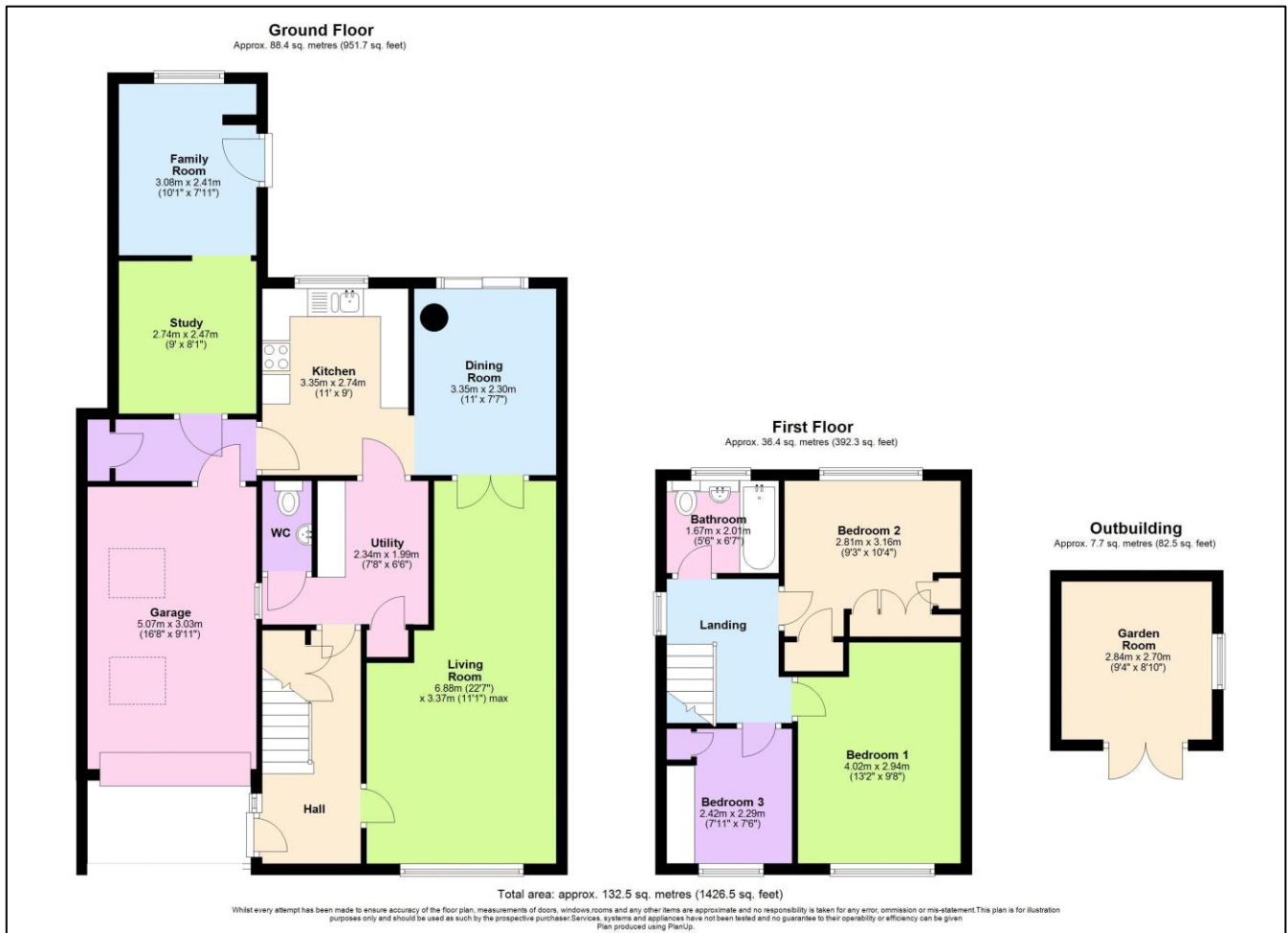

Find us online!



[www.samchiversproperty.co.uk](http://www.samchiversproperty.co.uk)



Facebook: Sam Chivers Estate Agents



Instagram: @samchiversestateagents

rightmove Zoopla

Score	Energy rating	Current	Potential
92+	A		
81-91	B		83 B
69-80	C	69 C	
55-68	D		
39-54	E		
21-38	F		
1-20	G		

Sam Chivers Estate Agents can also provide mortgage and conveyancing recommendations should you require such a service. Please contact our office on:

01761 411020 or email us at [sales@samchiversproperty.co.uk](mailto:sales@samchiversproperty.co.uk)

These sales particulars provide an approximate guide and form no part of a contract. It is the purchaser's responsibility to satisfy themselves that the property has been accurately described and that all fixtures and apparatus are functioning correctly. Your home may be at risk if you do not keep up repayments secured against it.